

CODE: **AWO453** v1.4/II
 NAME: **EXPANDER 2**

EN

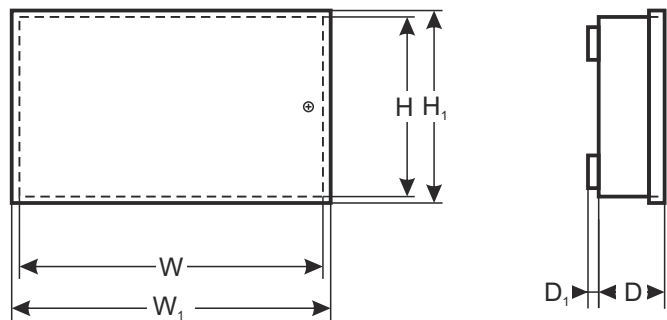

DESTINATION

SATEL:

- 1) 3x (CA10E, CA64E, SM, MST1)
- 2) 2x CA64 (EPS, O-OC, O-ROC, O-R, VGM-16, SR, ADR, ACC-KP, PS)+ CA10E (MST1)
- 3) CA64 (EPS, ADR, O-R, O-ROC, O-OC, VGM-16, SR, ACC- KP- PS)+ 2x (CA10E, CA64E, SM, MST1)
- 4) CA64 (PP, OPS- OC, OPS-R, OPS-ROC) + CA64 (EPS, ADR, O-R, O-ROC, O-OC, VGM16, SR, ACC-KP-PS)
- 5) CA64 PTSA

DSC:

- 1) 4x (4108, 5108, 6108, 5208, 5100, 4116)
- 2) (4108, 5108, 6108, 5208, 5100, 4116)+ (4216, 4580, 5400, 5580)
- 3) 1x (4216, 4580, 5400, 5580)

PARADOX:

- 1) 3x (ZX4, ZX8, ZX8SP, HUB2, PGM4)
- 2) ADM2+ 2x (ZX4, ZX8, ZX8SP, HUB2, PGM4)

RISCO:

- 1) 2x (EZ8, EZ16, E04, E08)

TECHNICAL DATA

External dimensions of the enclosure:	W=262, H=172, D+D ₁ =50+8 [+/- 2mm]
External dimensions of the front panel:	W ₁ =266, H ₁ =175 [+/- 2mm]
Weight netto/brutto:	0,80kg / 0,90kg [+/-0,1kg]
Operating environment:	class II, -10°C+ 40°C
Material description:	sheet steel DC01, thickness: 0,7mm, protection anticorrosion, color: RAL 9003
Destination:	indoor
Tamper protection:	1 x microswitch: opening, 0,5A@50V/DC max. NC- contacts
Closing:	screwed x 1
Notes:	distance from wall (mounting surface) - 8mm
Declaration, warranty:	CE, 2 year from the production date